



Small body, big flexibility.



## Parameters

Classification	Parameter	Measurement range			Measurement time (min.)		
		Unit (A)		Unit (B)			
Biochemical tests	ALP	14 - 1183	U/L	0.23 - 19.76	μ Kat/L	4	
	v-AMY	100 - 2500	U/L	1.67 - 41.75	μ Kat/L	3	
	CPK	10 - 2000	U/L	0.17 - 33.40	μ Kat/L	4	
	GGT	10 - 1200	U/L	0.17 - 20.04	μ Kat/L	5	
	GOT/AST	10 - 1000	U/L	0.17 - 16.70	μ Kat/L	4	
	GPT/ALT	10 - 1000	U/L	0.17 - 16.70	μ Kat/L	4	
	v-LIP	10 - 1000	U/L	0.17 - 16.70	μ Kat/L	5	
	LDH	50 - 900	U/L	0.84 - 15.03	μ Kat/L	2	
	General chemistry	ALB	1.0 - 6.0	g/dL	10 - 60	g/L	6
		BUN	5.0 - 140.0	mg/dL	1.79 - 49.98	mmol/L	4
		Ca	4.0 - 16.0	mg/dL	1.00 - 4.00	mmol/L	4
		CRE	0.2 - 24.0	mg/dL	18 - 2122	μ mol/L	5
		GLU	10 - 600	mg/dL	0.6 - 33.3	mmol/L	6
		IP	0.5 - 15.0	mg/dL	0.16 - 4.84	mmol/L	5
		Mg	0.2 - 7.0	mg/dL	0.08 - 2.88	mmol/L	4.5
		NH <sub>3</sub>	10 - 500	μg/dL	7 - 357	μ mol/L	2
		TBIL	0.2 - 30.0	mg/dL	3 - 513	μ mol/L	6
		TCHO	50 - 450	mg/dL	1.29 - 11.64	mmol/L	6
		TCO <sub>2</sub>	5 - 40	mmol/L	5 - 40	mmol/L	5
		TG	10 - 500	mg/dL	0.11 - 5.65	mmol/L	4
		TP	2.0 - 11.0	g/dL	20 - 110	g/L	6
UA		0.5 - 18.0	mg/dL	30 - 1071	μ mol/L	4	
Electrolytes (on only one slide)	Na	75 - 250	mEq/L	75 - 250	mmol/L	1	
	K	1.0 - 14.0	mEq/L	1.0 - 14.0	mmol/L		
	Cl	50 - 175	mEq/L	50 - 175	mmol/L		
Immunological Test	vc-CRP	0.3 - 7.0	mg/dL	3 - 70	mg/L	5	
Comprehensive S-panel	TP, ALB, ALP, GLU, TBIL, IP, TCHO, GGT, GPT/ALT, Ca, CRE, BUN						
Pre-Surgical S-panel	TP, ALP, GLU, GPT/ALT, CRE, BUN						
Plus S-panel	TG, v-LIP, GOT/AST, v-AMY, Mg, Na-K-Cl						
Calculations	GLOB, ALB/GLOB, GOT/GPT, BUN/CRE, Na/K, Anion Gap						

\* Unit (A) and (B) is available  
 \* There are parameters which may not be available in your area. For details please contact your local distributor.  
 \* v-LIP, v-AMY and vc-CRP slides are designed for veterinary use.  
 Other slides are designed for use in analyzing human blood. Measurement results may vary depending on the animal species. For details, please contact your local distributors.

## Specifications

Measurement test	Colorimetry 23 tests Electrolytes 3 tests
Throughput	Colorimetry 120 test/ hour Combined 128 test/ hour
Number of sample rack	1
Number of incubator cell	Colorimetry 13, Electrolytes 1
Measurement time	Colorimetry 2 to 6 minutes/ test Electrolytes 1 minute/ 3 tests (Na, K, Cl)
Sample type	Plasma, Serum, Whole blood
Sample volume	Colorimetry 10μL/ test Electrolytes 50μL/ 3 tests (Na, K, Cl)
Data transmission to PC	RS 232C (1 port), USB (2 port), LAN (1 port)
Data print	Thermal printer
Electrical requirements	Single phase AC; 100 - 240 V ±10%; 50 to 60 Hz
Display	7 inch color touch panel
Dimensions	470 (W) × 360 (D) × 370 (H) mm
Weight	Approx. 27kg (NX600V IC) / Approx. 26kg (NX600V)
Operating temperature	15 to 32°C (59 to 89 °F)
Operating humidity	30 to 80% RH (no vapor condensation)
Altitude	Up to 2,000m (810 hPa)

## Dimensions (mm)



## NX600V Series Products

	With electrolyte measuring function	With automatic dilution function	With centrifugal separation function
NX600V IC	●	●	●
NX600V	●	●	—

## Option Items

### Barcode Reader

Barcode reader is available as option item to read sample ID on sample tube.



DRI-CHEM NX600V (Product name: FUJII DRI-CHEM NX600V IC, FUJII DRI-CHEM NX600V, FUJII DRI-CHEM NX600iV)

Read more about our Medical Solutions: [www.fujifilm.com](http://www.fujifilm.com)



# FUJIFILM

FUJIFILM Corporation

26-30, NISHIAZABU 2-CHOME, MINATO-KU, TOKYO 106-8620, JAPAN  
<http://www.fujifilm.com/products/medical/>

Ref. No. NX600 VET E FXX-XB-0400 (21-01-F1079-F8598) Printed in Japan ©2020 FUJIFILM Corporation

10μL  
/test

Automated Clinical Chemistry Analyzer **NEW**

# DRI-CHEM NX600V

For veterinary

## 3-step easy measurement



Using the item code recorded on the slide, the item and lot number are automatically identified. After pressing the start key everything through the printing of the measurement data is fully automatic.



### One pack panels (s-panels)

Set multiple required items at once

One pack panels are also available. There is no need to open individually packed slides in a panel. This improves work efficiency and reduces waste.



One pack panels



Individually packed slides in a panel

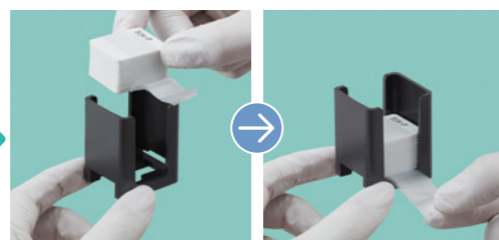

Simply place it in the slide cartridge and remove the binding tape

### Measure directly from whole blood

Built-in centrifugal separation unit\*

Simply insert the whole blood in the dedicated IC cup and place the cup in the unit. Automatically execute everything from plasma extraction to analysis. \*NX600V IC



#### Can also measure serum and plasma separated by external centrifugation

This is possible when there is a need to reduce the amount of blood sampled or use the plasma sample in other tests.



### Continuous measurement

Reduce waiting time

As soon as the pipetting procedure for the first sample is completed, the slides for the next sample can already be set and the test started. This minimizes waiting time for your patients.

NX600V processing cycle in minutes for 18 clinical parameters per patient sample

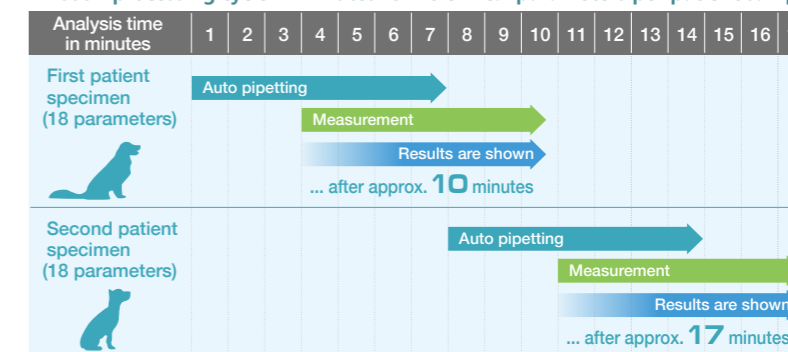

\* In case of whole blood samples, it will take another 2 minutes for the centrifugation for each sample.



# Improved design supports smooth workflow

## User-friendly Fujifilm design

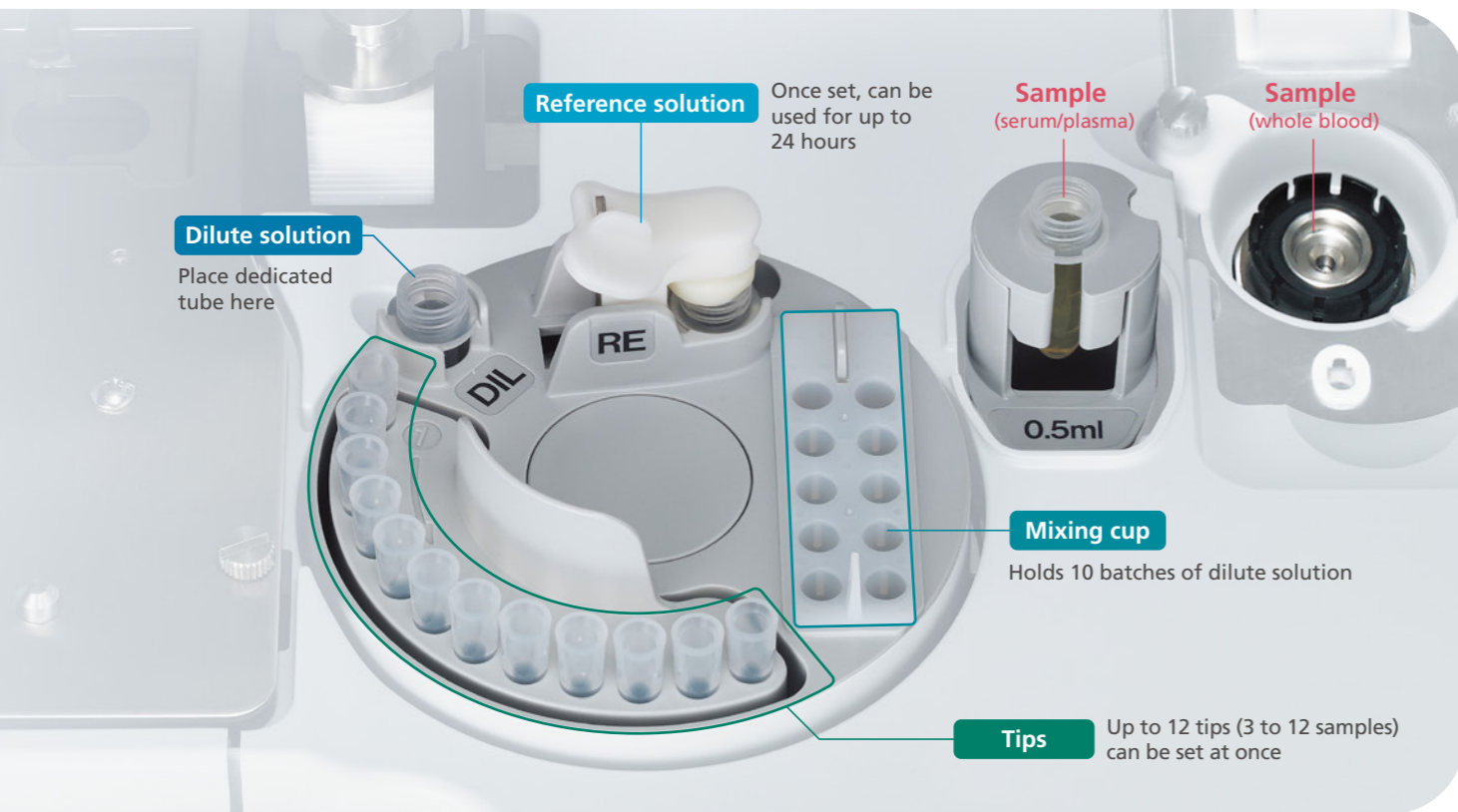

### Set consumables for multiple samples at once

The layout is simpler than our previous models, and this makes it easier to set consumables. Multiple tips can be set at once, which eliminates the need to set reference solution for each measurement. This reduces the frequency of consumable replacement.



### Large 7-inch intuitive LCD touch panel

The simple and easy-to-use operation screen provides a swift transition speed of 0.5 seconds or less for stress-free operation. A rich variety of help screens are also provided. This enables easy operation while checking illustrated usage and maintenance procedures.

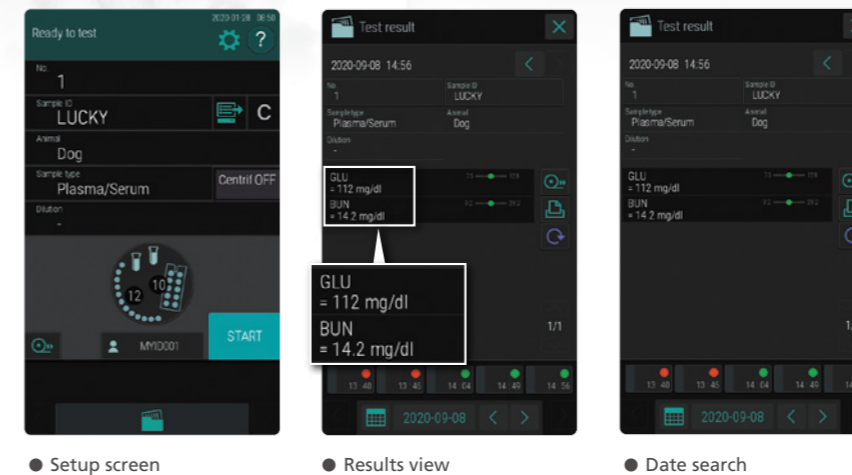

● Setup screen      ● Results view      ● Date search

## A rich variety of functions for flexible support

**10 $\mu$ L /test** **Microsample testing**

Only 10  $\mu$ L of sample is required for each test. (CRP: 5 $\mu$ L/test, ISE: 50 $\mu$ L/test, dead volume is necessary using automatic measurement.) A very useful feature especially in small animals. If there is less sample, measurement can be done by manual pipetting.

**128 test/h** **High throughput**  
128 tests can be processed per hour.

**Automatic dilution function**  
Labor intensive operations like dispensing, mixing etc. are automated. The only user operation required is when selecting the dilution ratio.

**No Calibration**  
The FUJI DRI-CHEM system uses dry type reagents which are very stable. As the reagents are stable, calibration is not necessary and it utilizes a standard curve for the measurements. Variability in the reagent lots are adjusted using the QC card.  
\*ISE: Calibration and correction are not necessary. QC card is not attached.

**Easy reagent lot information input by QC card**  
Information for every reagent lot that are needed for the measurement are easily input into the machine using the QC card.

**Reduces biohazard risks**  
Used slides and tips fall automatically into a disposal box. Reduces the risk of contact with specimens.



# Achieve high-precision testing with reliable technology

High-quality slides utilize coating technology cultivated in the field of photography.

## FUJI DRI-CHEM SLIDE Two types of slides are provided for different test items.

**BUN-P**

**Colorimetric method slide**  
Enzymes, General chemistry, and Immunology

This multilayered slide is composed of dry chemical ingredients needed for the reaction and other functional materials. It quantifies enzymes and chemicals using colorimetric method.

**Potentiometric method slide**  
Electrolytes

Each slide comes with an ion selective film electrode for each of Na, K, and Cl. Slides quantify electrolytes in the sample by a potentiometric method.

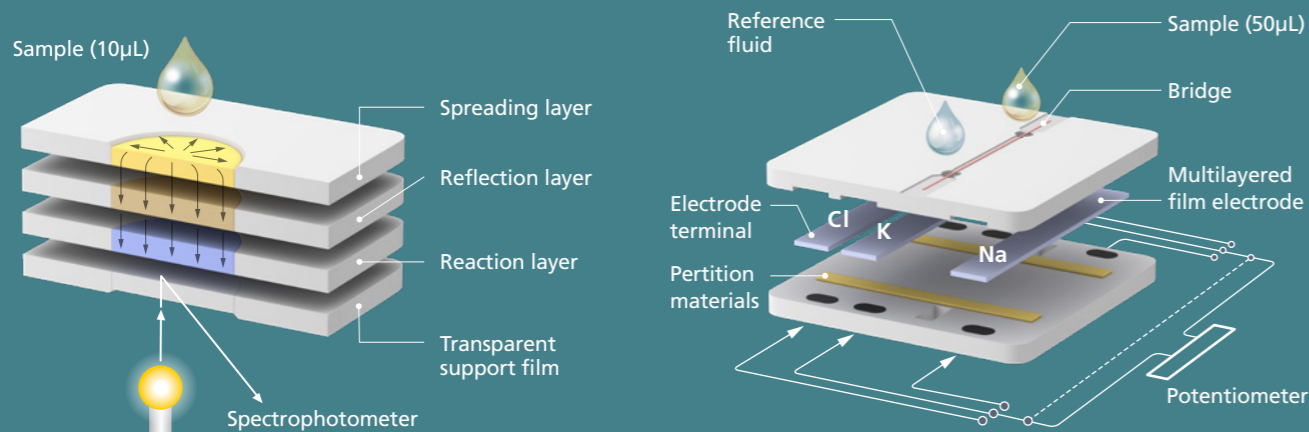

## Centrifugal separation cup (IC cup)

**Unique Fujifilm structure reduces risks**

Inserting a syringe into the straw included with the cup and injecting the sample prevents sample scattering. Furthermore, an internal structure with a separation layer and groove reduces hemolysis and promotes the stable supply of good quality plasma.

The straw can be easily removed simply by tilting it.

Centrifugal separation traps the blood cells with a large specific gravity on the outer side of the separating agent.

After separation, the plasma follows the groove and accumulates separately in the bottom of the cup.

- Serum
- Plasma
- Separating agent

# Based on technology and experience developed over many years, Fujifilm DRI-CHEM provides conclusive test results

Fujifilm DRI-CHEM slides achieve an extremely high degree of precision thanks to a special filter layer that reliably filters out any substances that could interfere with the serum or plasma specimen. The high quality of Fujifilm reagents is demonstrated by a comparison with the standard measurement methods.

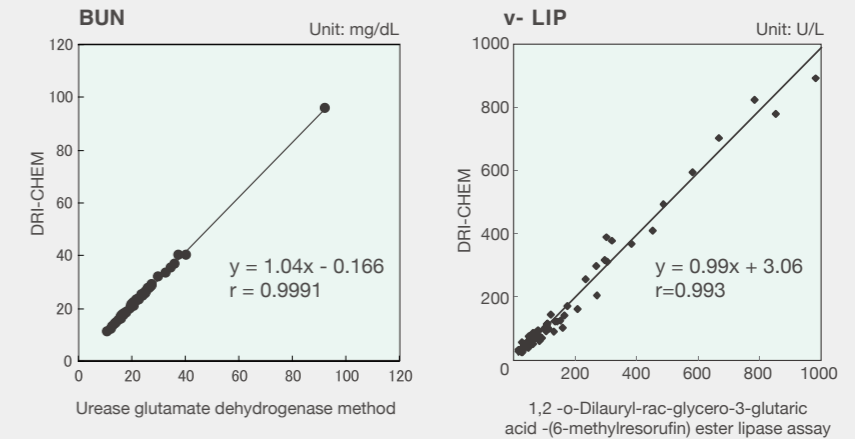

## Realtime diagnosis canine CRP test for inflammation screening

NX700V can measure lipase activity for canine CRP with the rest of the biochemistry test items.

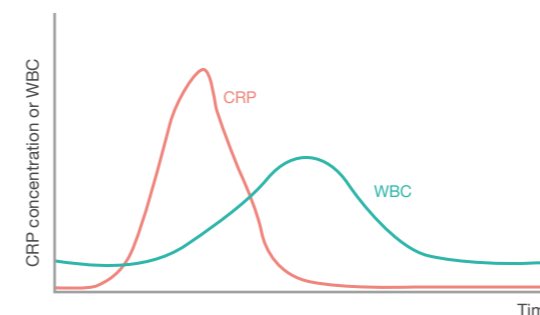

## NX600V can measure lipase activity for canines

Lipase activity, which is useful for the screening of pancreatitis, can also be easily measured. This contributes to quick screening of pancreatitis onsite.

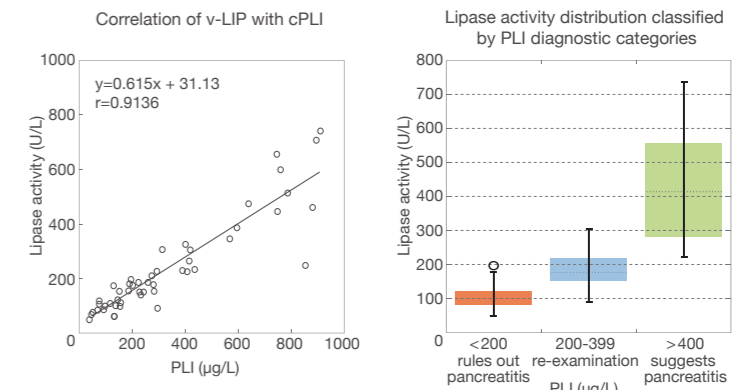

Citation: J. Vet. Med. Sci. 73(11):1481-1483, 2011 Katsumi Ishioka J-vet vol.291 2011.6 pp13-15, pp25-29

## DRI-CHEM product lineup providing total in-house diagnostic testing



**DRI-CHEM NX700V**  
Clinical chemistry analyzer

- High throughput 190 test/ hour (colorimetry and ISE combined)
- 5 sample rack • Without centrifugal separation unit



**DRI-CHEM NX600V**  
Clinical chemistry analyzer

- Single sample rack



**DRI-CHEM IMMUNO AU10V**  
Immunoassay analyzer

- v-T4, vc-TSH, v-COR, v-BA, v-PRG, vf-SAA